

Renaissance

Issue 14
April 2024



A Challenging Second Half of 2024

Mr Yong Yih Ming
Chief Operating Officer, IHH Healthcare Singapore
Chief Executive Officer, Mount Elizabeth Hospital

Dear Colleagues

Project Renaissance is well on track. The upcoming months in the latter half of 2024 are anticipated to present significant challenges, and we seek your continued patience and understanding. By Q1 2025, 90% of the key assets would have been completed.

Four key areas in Mount Elizabeth Hospital (MEH) and the Medical Centre (MEMC) will undergo massive renovations. These would require some pre-emptive planning, adjustments and communications for everyone.

In this edition, we will highlight these four areas:

1. MEMC Drop-off Point
2. MEH Wards (Levels 6, 7, 8, 9 and 10)
3. MEH Main Lobby
4. MEH Level 1 Back-of-House Zone



Mr Yong Yih Ming
Chief Operating Officer, IHH Healthcare Singapore
Chief Executive Officer, Mount Elizabeth Hospital

Project
Renaissance
Newsletter

TABLE OF CONTENTS

Introduction
• P.1

MEMC Drop-off
• P.2

Wards Closure
• P.3

Hospital Lobby Closure
• P.4-5

Service Area
• P.6

MOUNT ELIZABETH MEDICAL CENTRE DROP-OFF POINT

(planned for July 2024 through January 2025)



The current Mount Elizabeth Medical Centre (MEMC) Drop-off Point, including the landscaping around it, will be totally overhauled to make way for a new canopy that would coincide with the construction of the new linkway to Lucky Plaza.

During this renovation period, the pedestrian walkways leading towards Paragon and Lucky Plaza will still be available while vehicular traffic and drop-off points will be adjusted at different phases and times to optimise the convenience for our patients (for e.g., both vehicular lanes will be shut down during the demolition of the entire canopy, and then one lane would be accessible when constructing the new canopy at different phases).

MEMC DROP OFF

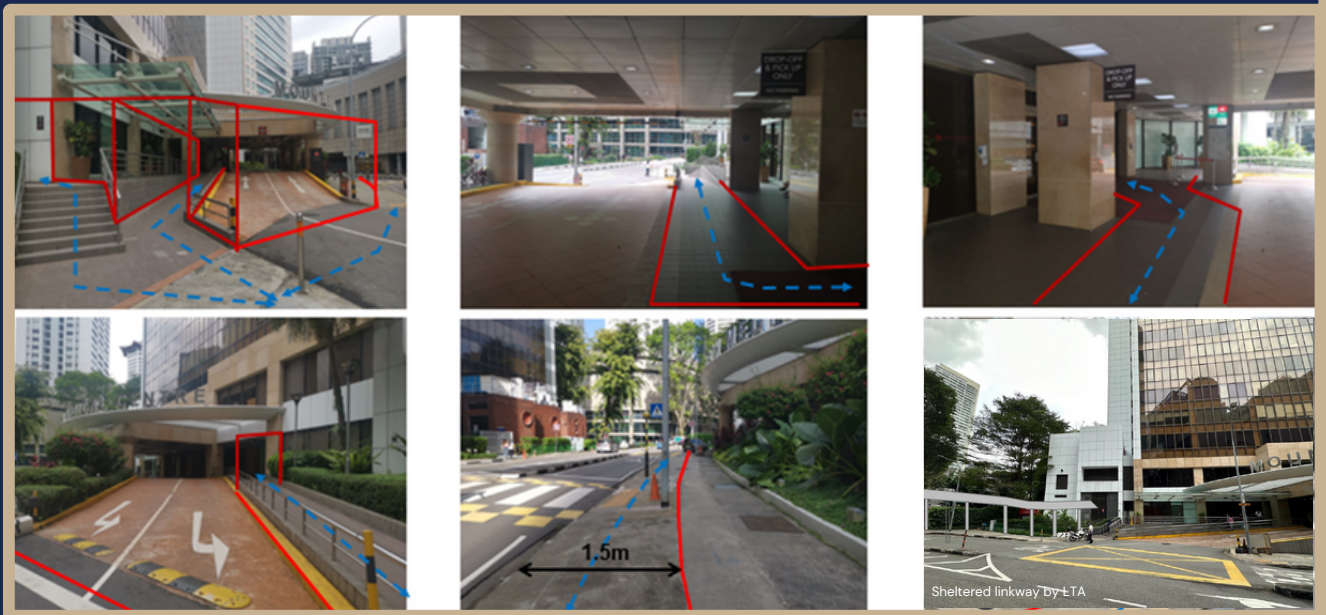

We will be coinciding this with the construction of the sheltered linkway to Lucky Plaza based on the latest advisory from the authorities.

Wards – Levels 6, 7, 8, 9 & 10

(staggered across June 2024 through January 2025)

HOSPITAL WARD

Levels 6, 7, 8, 9 and 10 at Block B will be progressively taken over during this period to renovate the wards, stairways and to introduce the new smoke-stop lobbies due to the vertical technical and infrastructure interdependencies of this block.

We will be communicating the bed management plans very soon as up to 99 beds of all types will be affected during this phase. To sustain capacities, we will optimise and multi-task all bed types with quicker turnaround and careful planning.

The Intensive Care Units (ICU), High Dependency Unit (HDU), Operating Theatres and Endoscopy Suites will largely operate at optimum capacities during this period.



“At the end of this phase, 90% of the wards would be completed.”

For now, we encourage all admitting doctors to consider the following:

- (1) Plan your annual leaves during this period so that we can spread out the admissions, where possible;
- (2) Plan your admissions ahead of time to avoid that period, especially for electives; and/or
- (3) Consider admitting patients into our sister hospitals during that period.

More details to follow.

MOUNT ELIZABETH HOSPITAL

MAIN LOBBY

(planned for July 2024 through January 2025)



Future Lobby

Our main lobby will be hoarded up from June 2024 for a major facelift. We can look forward to a totally reconfigured layout, a new vehicle drop-off, brand new visitor lifts, concierge, seating lounges, a new feature wall and new skylight atrium.

The mainstays of the Guan Gong mural, the big flower vase, the piano and most of our original marble tiles with gold trimmings will continue to be featured at our new lobby.



**Artist impressions



Future Driveway and Drop-off



During the renovation, temporary corridors and drop-off points will be set-up to facilitate patient and visitor movements. The Business Office and Front Office will also be operating at temporary locations during this period. More details will be advised nearer to the date.

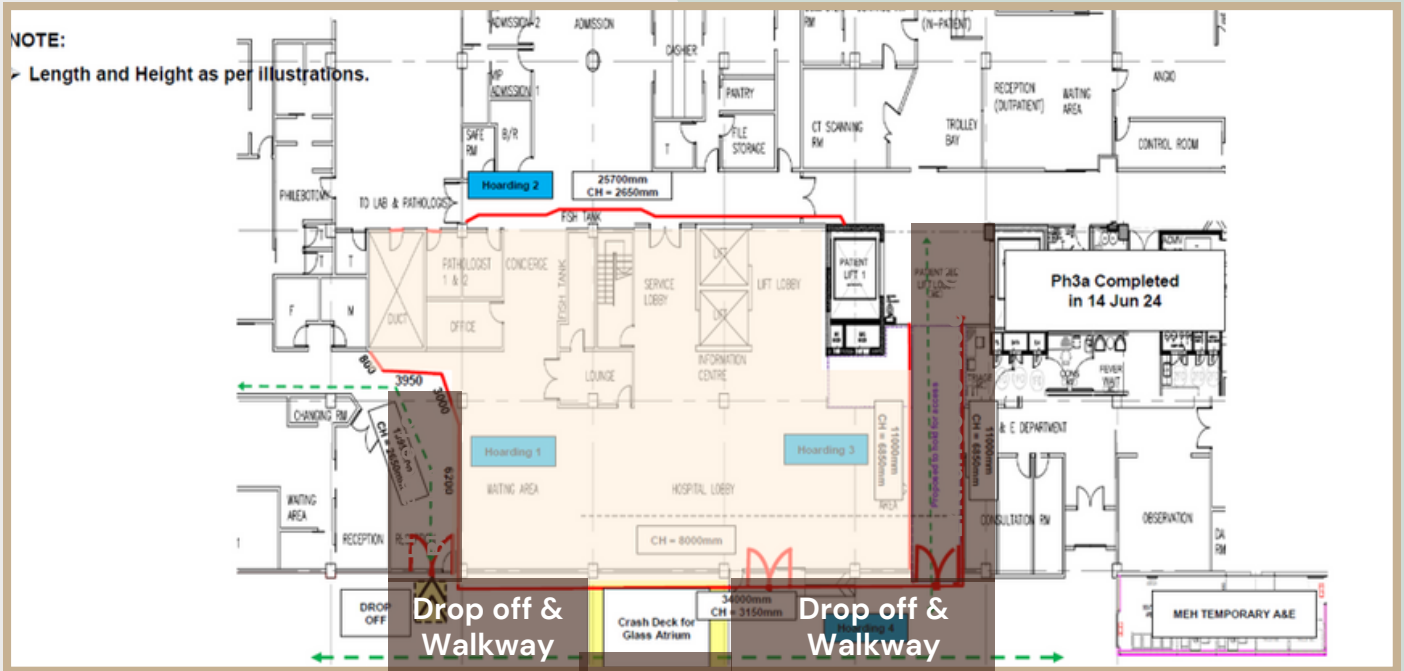

Entrance Access to Block B & Medical Centre

Patient Lifts at Block B (Level 2 to 6),
Temporary Business Office & Front Office,
New Clinical Laboratory, Hospital
Pharmacy, Day Ward, Labour & Delivery
Ward, Medical Centre, Retail Outlets.



Upcoming

Existing hospital lobby will be hoarded up to commence lobby and sky atrium renovation

Entrance Access to Block C

New Patient Lift at Block C (Level 2 to 5),
Main Radiology, CVL, Radiation Oncology,
OT, ICU, NICU, New Endoscopy Centre,
NICL, Ward 5A, Urgent Care Centre

New Temporary Entrance with a crash deck will be created

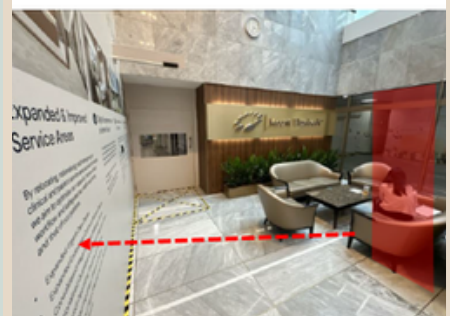

MOUNT ELIZABETH HOSPITAL BACK-OF-HOUSE AT LEVEL 1 (STAGGERED BETWEEN JUNE 2024 TO MAY 2025)

The entire staff area and nuclear medicine space on Level 1 will undergo massive re-configuration to introduce a new Building Management Command Centre, better workflow circulation, and to re-locate the nuclear medicine unit.

This will also start the process for the construction of the new Block B drop-off point by the current carpark exit gantries.



Drop-off point at Block B, in front of Carpark Office & Security Office

During this period, operational support units & areas (as follow), will all have temporary arrangements to ensure our support for patient care remains uninterrupted.

- Biomedical Engineering (BME)
- Environmental Services (ES)
- Facilities Management (FM)
- Food and Beverages (FnB)
- Security
- Kitchen
- Cafeteria
- Laundry
- Staff Change Room
- Store
- Mortuary

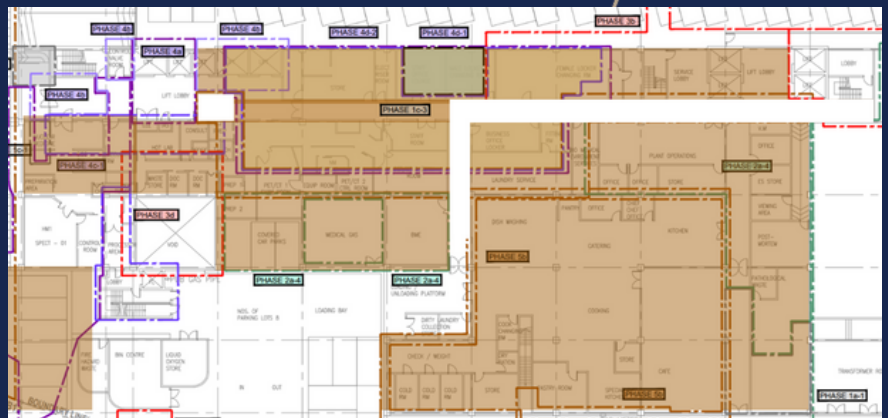

For the next edition of Renaissance, I will be providing more specific plans relating to these four major renovation phases.